



**Trademark**  
SOUNDPROOFING

# INSTALLATION INSTRUCTIONS

These installation suggestions consist of a common process for baffle installation. Installers should rely upon their own professional experience and understanding of their unique requirements to ensure a successful install.

## ITEMS INCLUDED

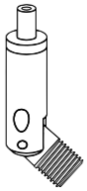

Jointed Gripper

## OPTIONAL SINGLE STRAND TO DECK INSTALLATION METHOD



Sputnik assembly and cables with ball ends

## MULTIPLE CABLE METHOD



## OPTIONAL SINGLE STRAND TO DECK INSTALLATION METHOD

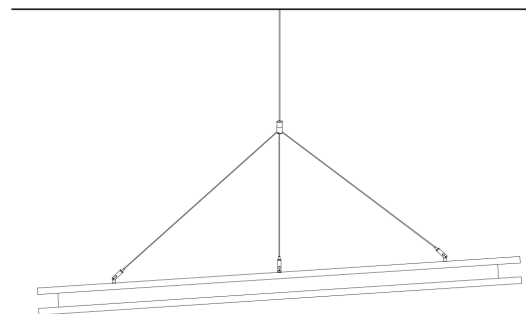



**Trademark**  
SOUNDPROOFING

# INSTALLATION INSTRUCTIONS

## MULTIPLE CABLE METHOD

1. Press and hold the channel nut tip to insert the cable.

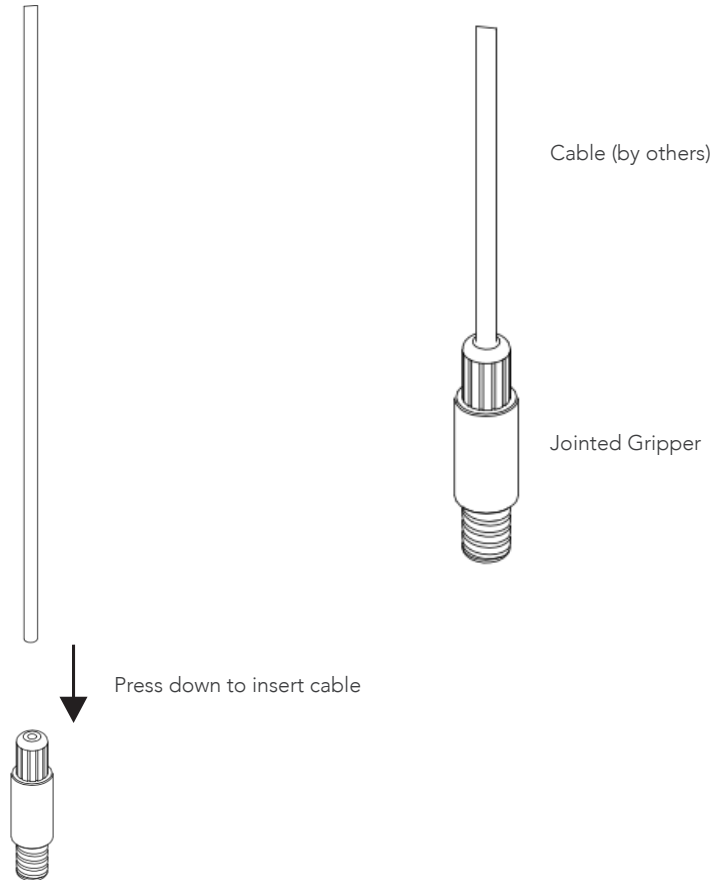

2. Locate the 1/4" threaded hole and screw in the jointed gripper.

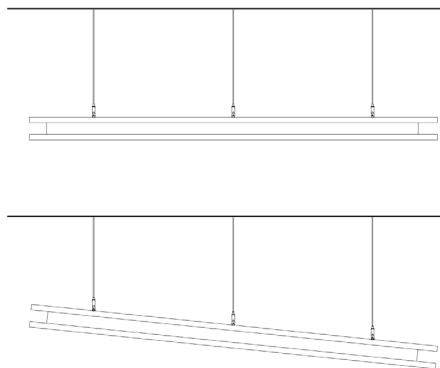



**Trademark**  
SOUNDPROOFING

# INSTALLATION INSTRUCTIONS

## OPTIONAL SINGLE STRAND TO DECK INSTALLATION

1. Insert the cable into the sputnik head.

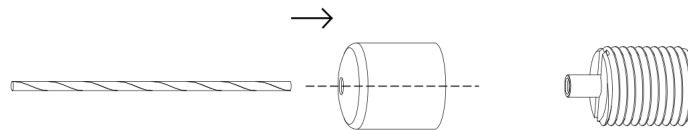

2. Insert the cable into the threaded head.

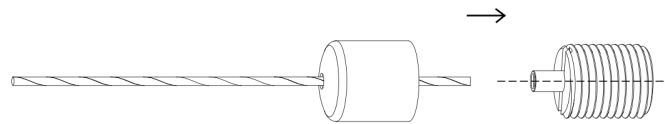

3. Screw it to the sputnik head.

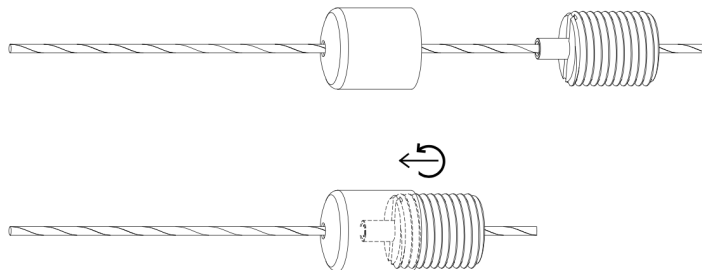



**Trademark**  
SOUNDPROOFING

## INSTALLATION INSTRUCTIONS

4. Insert cables to the bottom exit.

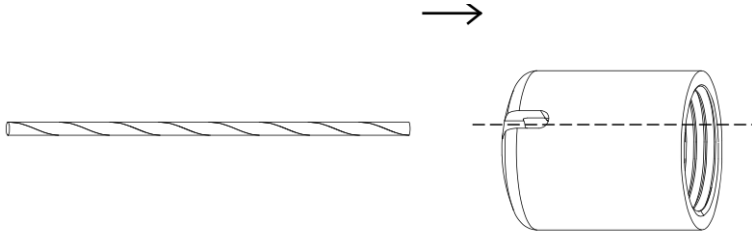

5. For the STRATUX CLOUD Circle use (3) included cables with ball ends to attach on the bottom exit; use (4) for the STRATUX CLOUD Square (not shown).

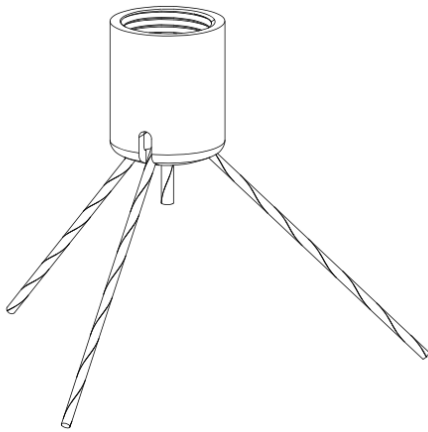

6. Screw it back to the sputnik head and cut excess wire.

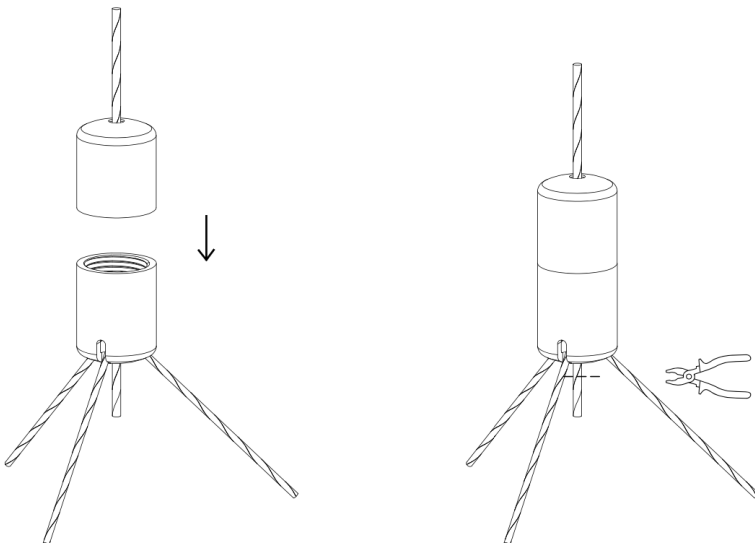



**Trademark**  
SOUNDPROOFING

## INSTALLATION INSTRUCTIONS

7. Locate the threaded hole to mount the jointed gripper.

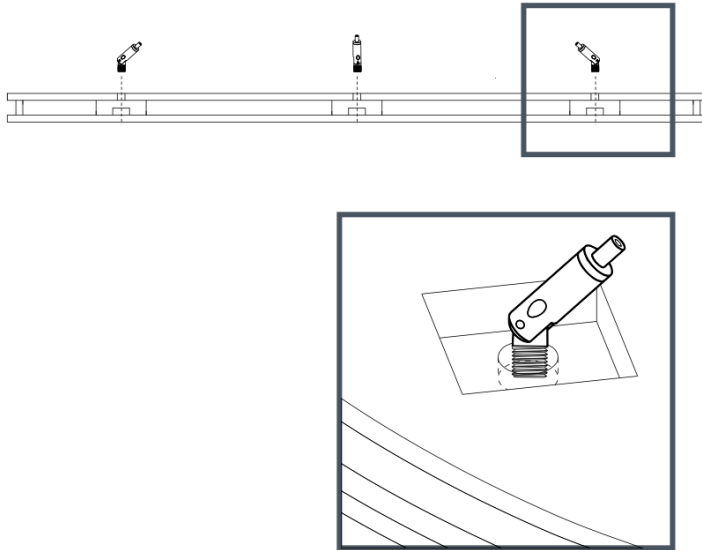

8. Press and hold the spring portion to insert the cable.

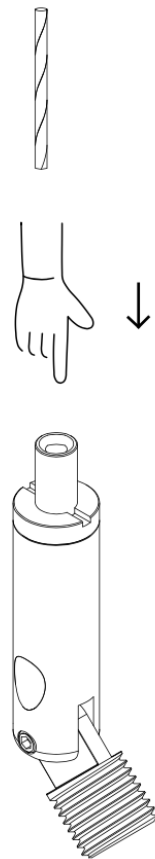



**Trademark**  
SOUNDPROOFING

## INSTALLATION INSTRUCTIONS

9. After insert cut out the excess cable.

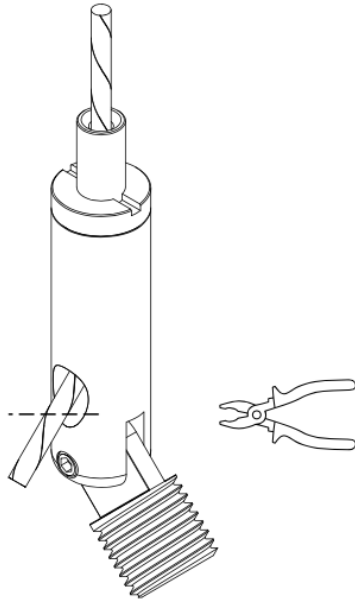

10. Finished assembly. Cloud can be hung at different lengths.

