



Trademark
SOUNDPROOFING

Sound Absorption Panel

NRC Testing

Sample Name	Fabric Acoustic Panel	Size	1200mmx600mmx60mm
Series No.	A17-241	Sample No.	A17-241
Date of Sending Sample	2017-07-31		
Testing Date	8/3/2017	Test Type	Entrusting Test
Test Item	Sound Absorption Coefficient	Quantity of Sending Sample	10.08m ²
Test Standards	GB/T 20247-2006/ISO 354:2003 "Acoustics- Measurement of sound absorption in a reverberation room"		
Test Conclusion	NRC = 0.90, GB/T16731 - 1997 The test sample NRC = 0.90. According to GB/T16731 - 1997 "The gradation of sound absorption property for absorbent products", the absorption property of the tested acoustic structure is the 1st class		
Notes	GB/T 16731-1997: GB/T 16731-1997 "The gradation of sound absorption property for absorbent products" provides 4 classes of sound absorption level: I 1st Class: NRC ³ 0.80, II 2nd Class: 0.80 > NRC ³ 0.60, III 3rd Class: 0.60 > NRC ³ 0.40, IV 4th Class: 0.40 > NRC ³ 0.20		

www.tmsoundproofing.com

Phone: 845-388-1200 | Fax: 845-388-1388



Trademark
SOUNDPROOFING

Sound Absorption Panel

NRC Testing

Series No.	A17-241							Test Equipment				RTA840 System									
Test Results																					
Frequency (Hz)	100	125	160	200	250	315	400	500	630	800	1000	1250	1600	2000	2500	3150	4000	5000	ā	NRC	
Sound Absorption Coefficient	0.59	0.81	0.76	0.83	0.72	0.90	0.94	0.91	0.95	0.93	0.96	0.97	0.99	0.99	0.94	0.94	0.99	0.98	0.89	0.90	

1- $\bar{\alpha}$ is the arithmetic mean value of absorption coefficient from 100Hz to 5000Hz.

2- NRC is the noise reduction coefficient, it is the arithmetic mean value of sound absorption coefficient of four octave bands which are 250, 500, 1000, 2000 Hz (see GB3947).

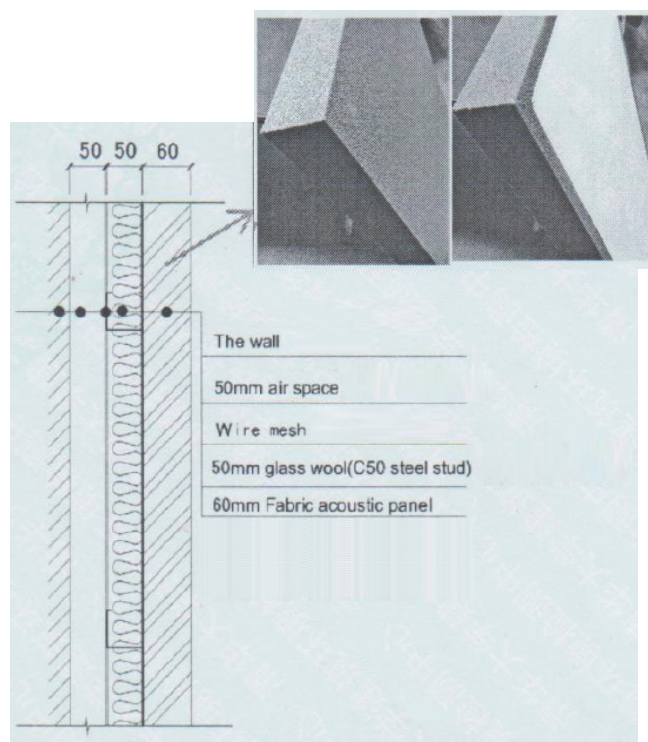
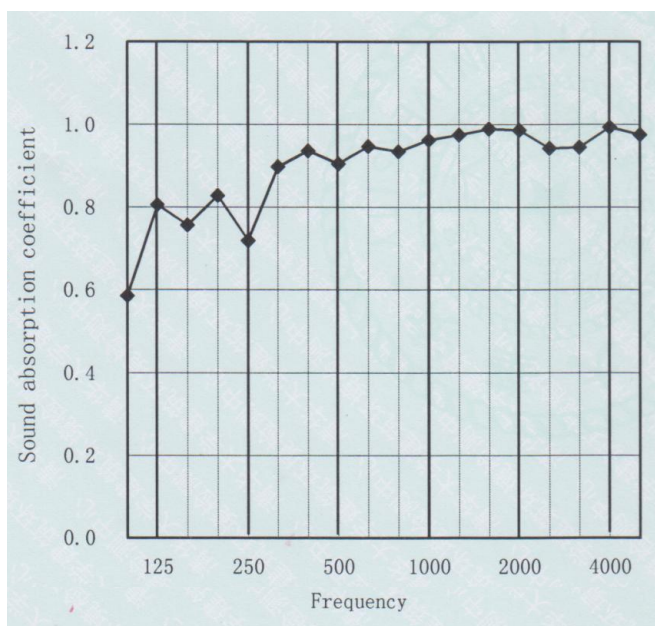

Notes

1. The sample size: 1200mm x 600mm x 60mm, surface density: about 4.7kg/m².
2. Size and installation method: 4.2m x 2.4m Total 10.08² test material is installed in the reverberation room, surrounded by a 40mm thickness reinforced concrete slab envelope.
3. 100mm Space behind the test material, filled with 50mm thick glass wool, volume-weight: 32kg/m³, behind the glass wool is wire mesh, installation structure is shown above.

www.tmsoundproofing.com

Phone: 845-388-1200 | Fax: 845-388-1388