

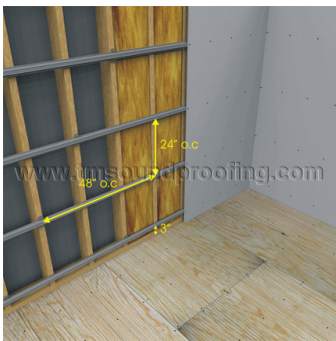

### Layout Pattern For Whisper Clips

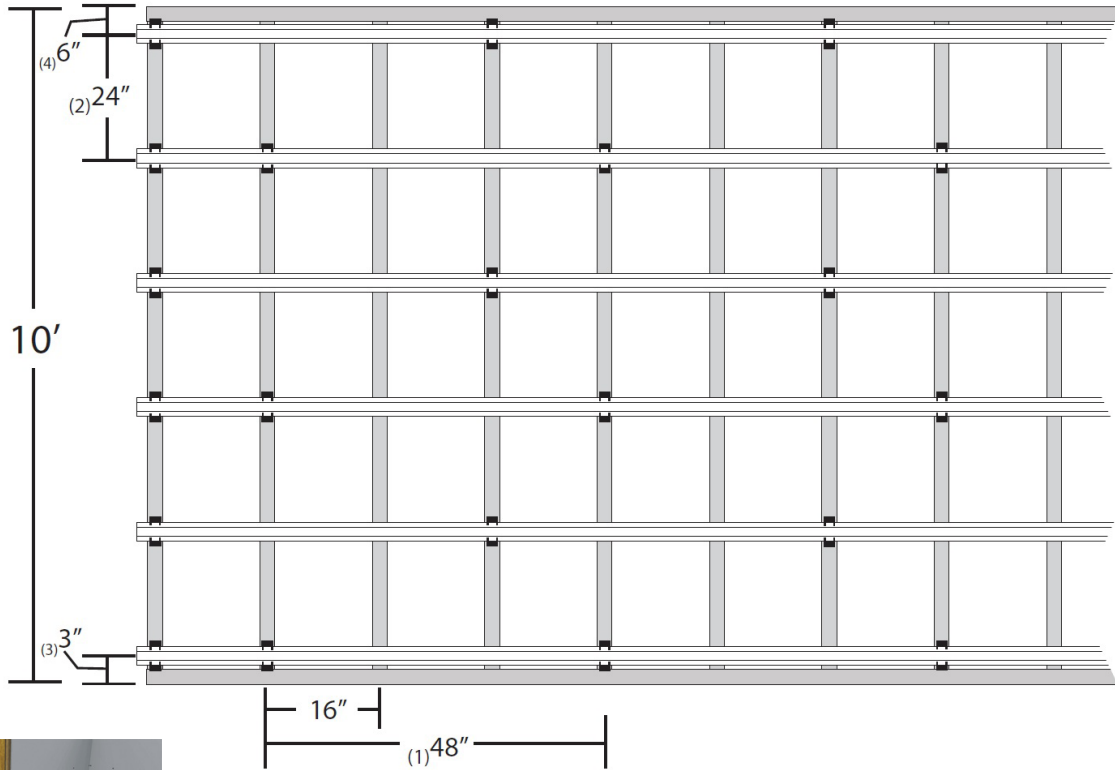

#### Whisper Clip Layout (Above and Left):

- (1) Clips are spaced no further than 48 inches apart horizontally
- (2) Hat channel must not be spaced more than 24 inches vertically
- (3) Bottom clips must be less than 3 inches from the floor
- (4) Top clips must be less than 6 inches from the ceiling

\*Outermost clips must be spaced at every interval.

#### Note:

To distribute the weight of the drywall evenly, we recommend that you stagger the Clips on the studs or joists.

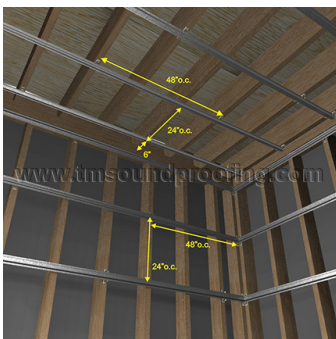

**How Many Do I Need?** As a general rule, figure one Whisper Clip for every 5 square feet (20% of total square footage). However, since more clips are required for the ends of the walls / ceiling, we recommending purchasing at least 23% of total square footage (multiply the total square footage by .23)



**Trademark**  
SOUNDPROOFING

# Whisper Clips

## Installation Guide

### STEP 1: APPLY WHISPER CLIPS



Measure for placement of Whisper Clips using layout guidelines listed above. Mark locations and install clips using appropriate screws, see below.

Note, Install ceiling drywall before walls to allow for a fire stop by butting ceiling drywall to studs, See diagram to the right.

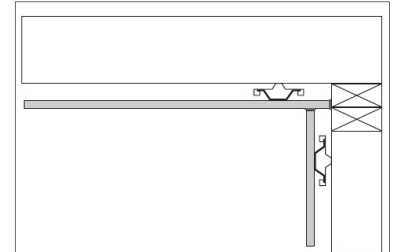

#### Recommended Screws by Stud Type:

- **Wood:** Use #8 x 2-1/2" coarse thread screws
- **Steel:** Use #8, 10 or 12 x 1-5/8" type S self-tapping screws
- **Concrete:** Use 3/16" diameter x 2-1/4" Tapcon or equal anchor screw

### STEP 2: APPLY HAT CHANNELS



Cut the hat channel to length using a pair of metal cutting shears. Once cut, fasten the hat channel into the Whisper Clip by inserting the bottom lip first and pulling down to snap the channel into place.

#### Recommended Hat Channel (See Below):

- **Walls:** 25 gauge hemmed edges
- **Depth:** 7/8"
- **Width Top:** 1 1/4"
- **Width Bottom:** 2 1/2"

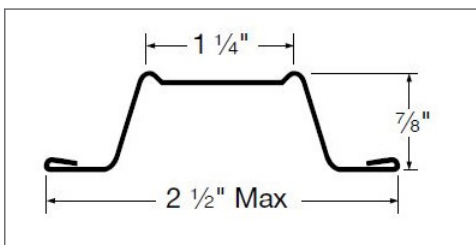

Most walls will require you to overlap hat channel, instructions for doing so are as follows:

Overlap 6" of hat channel between two clips. Secure the hat channel with two 7/16" framing screws. 18 gauge tie-wire can also be used.



**Trademark**  
SOUNDPROOFING

# Whisper Clips

## Installation Guide

### STEP 3: APPLY DRYWALL



Place 1/4" shims on the floor to allow spacing between the drywall and the flooring. This ensures decoupling from the floor to make it impossible for vibrations to travel from wall to floor and vice-versa.

Screw drywall in place through hat channel. While hanging your first layer of drywall, space screws on the channel according to your local building code.

**Recommended Screws:** For the first layer of drywall, use 1-1/4"

fine thread drywall screws with any additional layers being fastened with 1-5/8" coarse thread drywall screws.

Be sure not to use longer screws as they could penetrate the stud and couple the drywall to the frame, thereby creating a short circuit and reducing the benefits of the Clips.

Be sure drywall is fully installed before removing shims from underneath.

**Load Specifications:** Clips are designed to carry hat channels with one or more layers of wallboard attached. To load capacity depends on the spacing and number of clips used.

**Standard Clip Spacing:** 2 Clips to 1 Hat Channel, 25 Gauge- 45 lb. Maximum Load

When complete, clip and channel will space drywall a full 1-3/4" away from stud.

### STEP 4: APPLY ACOUSTICAL CAULK



Be sure to use an acoustical sealant to fill gaps around electrical boxes, windows, doors, and areas below and above sheets of drywall.

Green Glue's Acoustical Caulk is perfect for this application as it allows flexibility, while stopping sound from transmitting through unsealed areas.

Note, if applying a base board to the drywall, ensure that the base board is attached to the drywall only, and does not connect the wall to the floor, as this will create a short circuit thereby reducing the benefit of the clips.